

File name: \\USER02\LD\UK-CORP-PBW\NET\PROJECTS\70017468 - BRIDGE STREET, LEEDSIE MODELS AND DRAWINGS\DEVELOPMENT\AUTOCAD\IGA GENERAL ARRANGEMENT\70017468-GA-100_P03.DWG, printed on 25 May 2018 12:20:17, by Dawson, Mark

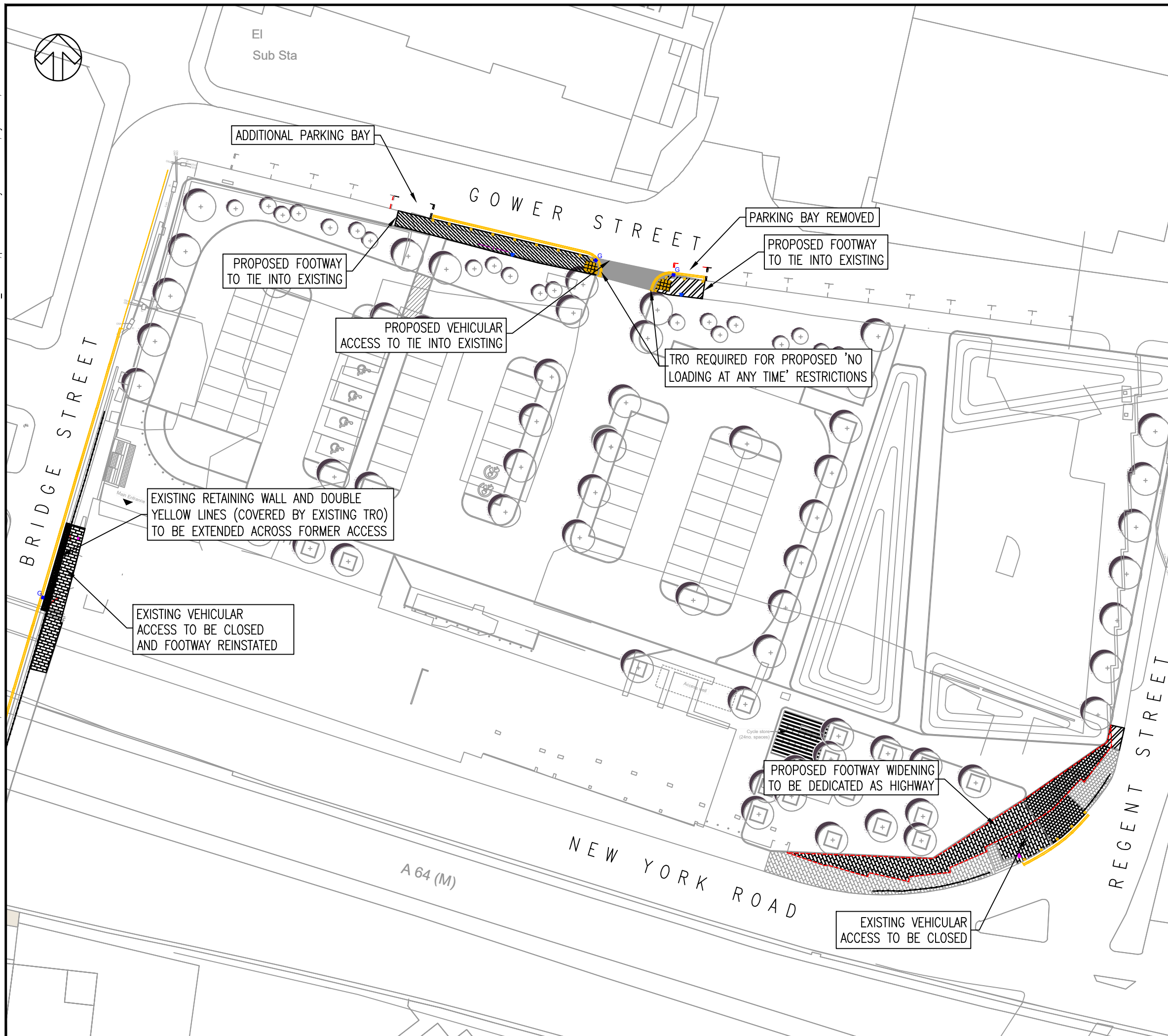

APPENDIX 3

HIGHWAY WORKS

REV	DATE	BY	DESCRIPTION	CHK	APP
P03	25/05/2018	MRD	ANNOTATION REVISED	DB	DB
P02	25/05/2018	MRD	REVISED TO SUIT LEEDS CITY COUNCIL COMMENTS	DB	DB
P01	24/05/2018	MRD	FIRST ISSUE	DB	DB

DRAWING STATUS:
S4 - FOR CONSTRUCTION APPROVAL



Three White Rose Office Park, Millshaw Park Lane, Leeds, LS11 0DL, UK
T+ 44 (0) 113 395 6200, F+ 44 (0) 113 395 6201
wsp.com

CLIENT:
ROBERTSON CONSTRUCTION LIMITED

ARCHITECT:
SIMPSON HAUGH AND PARTNERS

PROJECT:
SECTION 278 WORKS
BRIDGE STREET, LEEDS

TITLE:
PHASE 1 HIGHWAY ALTERATIONS
COMBINED GENERAL ARRANGEMENT

SCALE @ A3: 1:500
CHECKED: DB
APPROVED: DB

PROJECT No: 70017468
DESIGNED: MRD
DRAWN: MRD
DATE: May 18

DRAWING No: 70017468-GA-100
REV: P03

© WSP UK Ltd